

D 148 OSi

IRENET CONTROL STATION

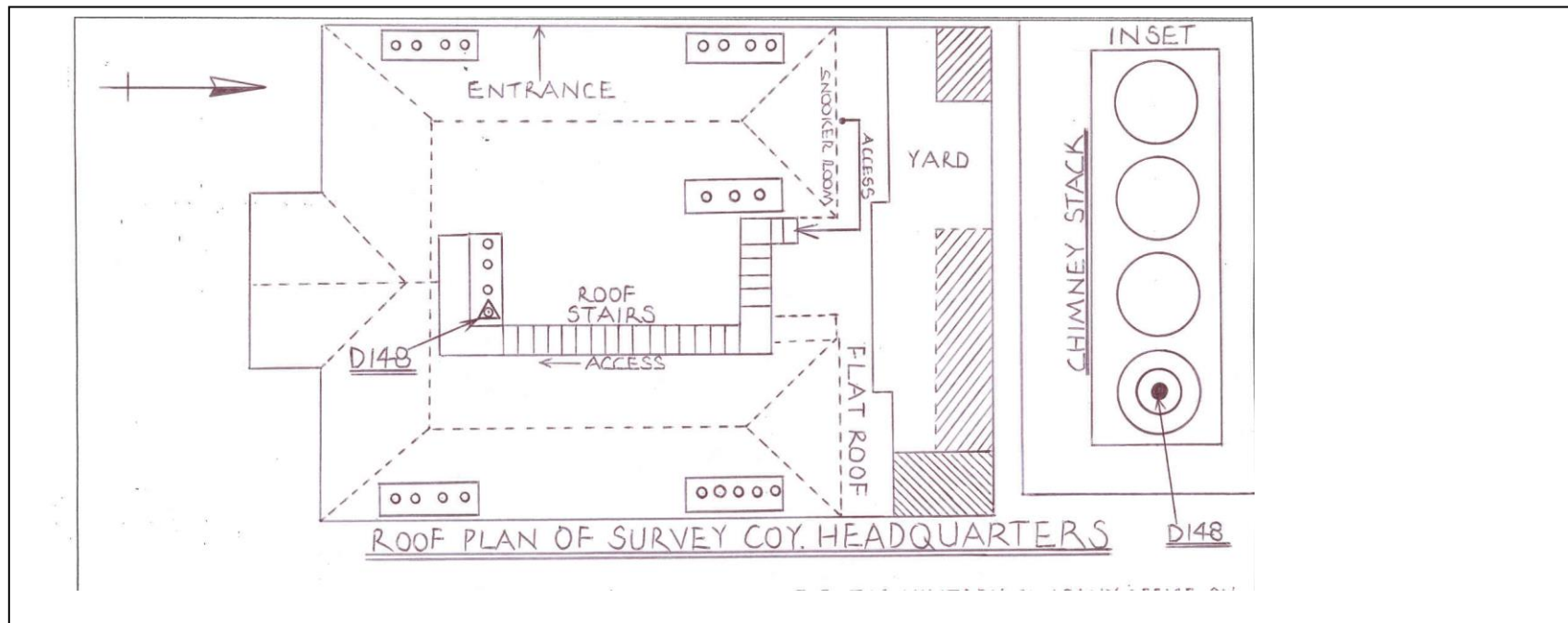

IRENET-95 COORDS. (ETRF89)

LAT 53°21' 51.38437"
 LONG. -06° 20' 56.35445"
 ELLIP. HT. 113.8860

ITM COORDINATES

Easting: 709885.081
 Northing: 736167.699
 Ht. (MSL mts)

IRISH GRID COORDINATES

Easting: 309958.266
 Northing: 236141.930
 Ht. (MSL mts) 57.671

WRITTEN DESCRIPTION

This station is located on the roof of the Survey Coy. Military Block. The mark is a copper circular plate with center bung fitted. The plate is set in the easterly chimney pot as shown and access is via the roof stairs, which is located via the snooker room on the first floor. Take the stairway to the chimney stack as shown in sketch.

Note: All measurements shown are in metres. Sketch is not to scale.

GEODETIC SURVEYOR :

DATE: 1995