

## IRENET CONTROL STATION D076 CAPPADAVOCK

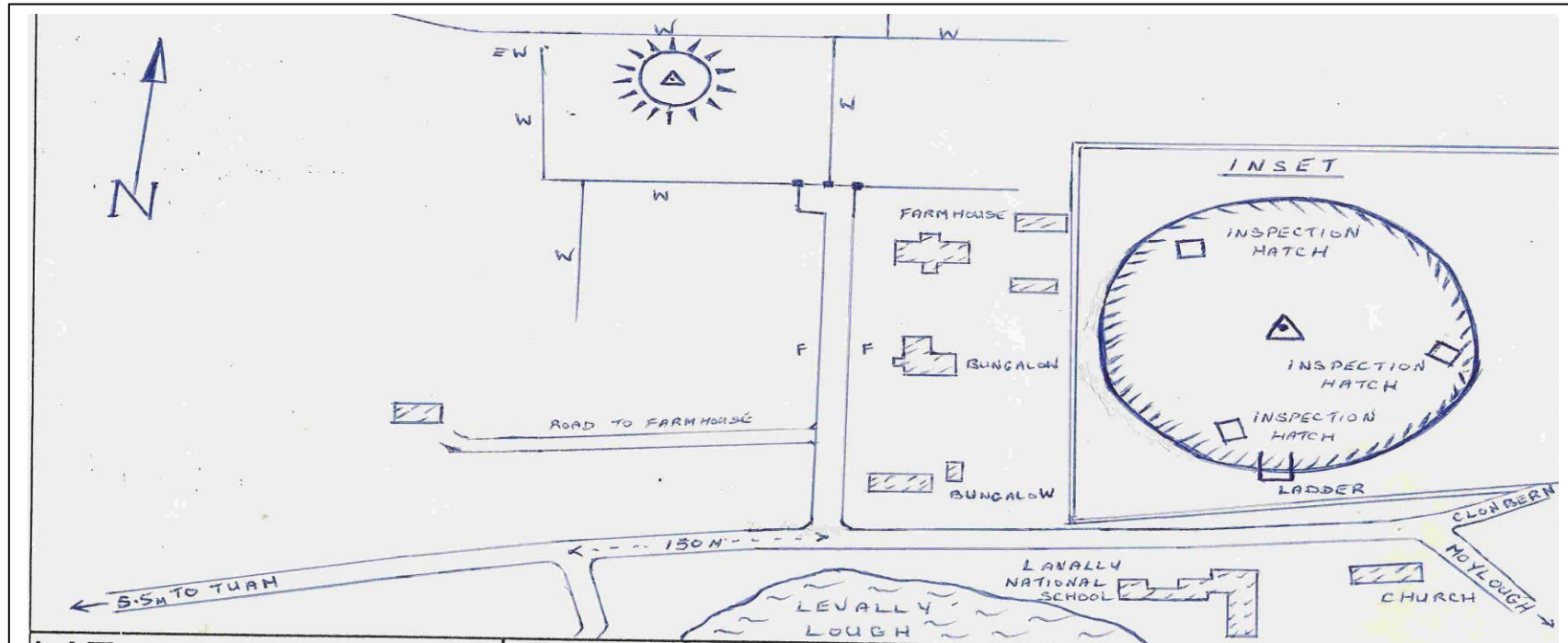

### IRENET-95 COORDS. (ETRF89)

LAT 53° 32' 17.87400  
 LONG. 08° 43' 19.06937  
 ELLIP. HT. 159.2610

### ITM COORDINATES

Easting: 552143.343  
 Northing: 754504.183  
 Ht. (MSL mts)

### IRISH GRID COORDINATES

Easting: 152182.107  
 Northing: 254481.581  
 Ht. (MSL mts) 101.724 (GPS level)

### WRITTEN DESCRIPTION

This station consists of a brass bolt set in a concrete block .61m x .52m square on top of circular reservoir. It is positioned approx in the center of the reservoir. The road leading to the reservoir is 5.5 E.N.E. of the town of Tuam on the Clonbern to Moylough road.

**Note:** All measurements shown are in metres. Sketch is not to scale.

**GEODETIC SURVEYOR :**

**DATE:**